

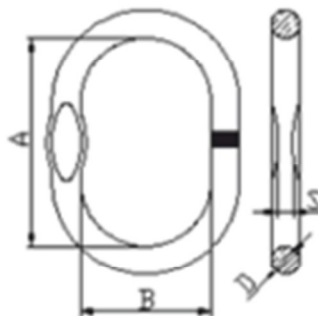

## Závěsné oko tř.10

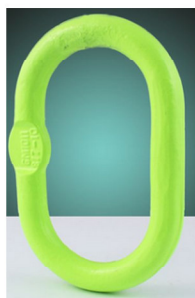

Rozměr Size	A mm	B mm	D mm	S mm	Váha Weight Kg	Prac. zátěž Working load T	Skúš. zátěž Proof force kN	Trhacia zátěž Breaking force kN
5	80	45	10	6	0.147	1.4	34.3	54.9
7/6	110	60	14	8	0.405	2.3	56.4	90.2
8/7	110	60	16	8	0.541	3.5	85.8	137.3
10/8	135	75	18	8.5	0.831	5	122.6	196.1
13/10	160	90	22.5	16	1.487	7.6	186.3	298.1
16/13	180	100	27	17.5	2.598	10	245.2	392.3
19/16	200	110	32.5	18	3.982	14	343.2	549.2
22/19	260	140	36	28	6.280	25.1	615.4	984.6
26/22	340	180	45	38	12.786	30.8	755.1	1208.2
32/26	350	190	50	39	16.700	40	980.7	1569.1

## Závěsná hlava tř.10

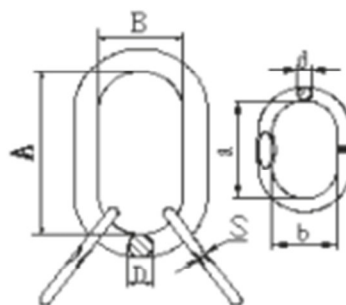
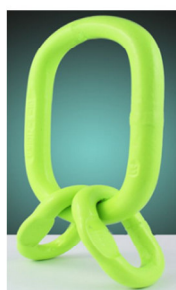

Rozměr Size	A mm	B mm	D mm	S mm	a mm	b mm	d mm	Váha Weight Kg	Prac. zátěž Work. load T	Skúš. zátěž Proof force kN	Trhacia zátěž Breaking force kN
6	135	75	18	7.5	54	25	14	1.258	3	73.6	117.7
8	160	90	22	8.5	70	34	16	2.196	5.3	129.9	207.9
10	180	100	27	11	85	40	18	3.645	8	196.1	313.8
13	200	110	32.5	14	115	50	22	5.840	14	343.2	549.2
16	260	140	36.5	18	140	65	27	10.454	21.2	519.8	831.6



**VAZAKY.com**

eshop vázacích prostředků a doplňků

## Hák s okem se záklopkou tř.10

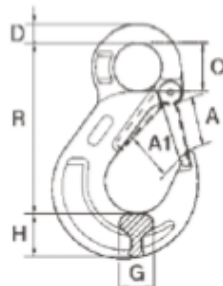
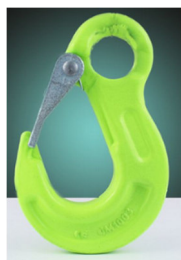

Na reťaz Chain		Kód Code	A	A1	D	G	H	O	R	Váha Weight	W.L.L.
mm	inch		mm	mm	mm	mm	mm	mm	mm	Kg	Kg
5-6	7/32-1/4	CAX 06SF	26	19	10	16	20	20,5	81	0,25	1400
7-8	9/32-5/16	CAX 08SF	33	26	11	19	29	25	101	0,50	2500
10	3/8	CAX 10SF	40	31	16	26	33	34	131	0,97	4000
13	1/2	CAX 13SF	51	40	19	33	42	43	159	1,90	6700
16	5/8	CAX 16SF	56	45	24,5	40	50	50	183	3,30	10000
20	3/4	CAX 20SF	60	52	27	48	53	55	203	4,50	16000
22	7/8	CAX 22SF	70	62	29	50	60	60	224	7,10	19000
26	1	CAX 26SF	77	73	35	60	75	70	257	12	26500

## Hák s vidlicí se záklopkou tř.10

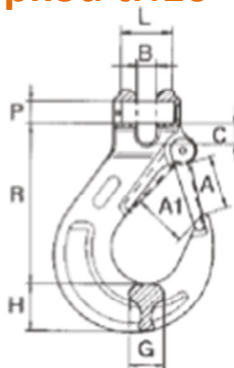

Na reťaz Chain		Kód Code	A	A1	B	C	G	H	R	PxL	Váha Weight	W.L.L.
mm	inch		mm	mm	mm	mm	mm	mm	mm	mm	Kg	Kg
5-6	7/32-1/4	CBX 06SF	26	19	7,2	8	15	20	69	7,5x17,5	0,25	1400
7	9/32	CBX 07SF	34	26	9,5	10	19	28	95	9x22,5	0,55	1900
8	5/16	CBX 08SF	34	26	9,5	10	19	28	95	10x22,5	0,50	2500
10	3/8	CBX 10SF	40	31	12	13,5	25	33	110	13x29,5	1,00	4000
13	1/2	CBX 13SF	51	40	15	17	30	40	136	16x37	1,70	6700
16	5/8	CBX 16SF	56	45	18	22	37	48	155	20x52	3,20	10000
20	3/4	CBX 20SF	60	53	23	26	51	52	185	24x73	5,00	16000
22	7/8	CBX 22SF	70	62	25	29	50	63	210	26x72	12,3	19000



## Řetěz tř.10

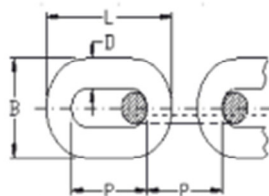

Rozměr Size (D)	D tol mm	P mm	P tol mm	B max mm	L max mm	Váha/m. Weight/m. kg	Pracovní zátěž Working load T	Skúšaná zátěž Proof force kN	Trhacia zátěž Breaking fore kN
6 mm	+/- 0.24	18	+/- 0.5	22.2	30.5	0.857	1.4	34.3	54.9
8 mm	+/- 0.32	24	+/- 0.7	29.6	40.7	1.510	2.5	61.3	98.1
10 mm	+/- 0.40	30	+/- 0.9	37	50.9	2.333	4	98.1	156.9
13 mm	+/- 0.52	39	+/- 1.2	48.1	66.2	3.900	6.7	164.3	262.8

## Řetězová spojka tř.10

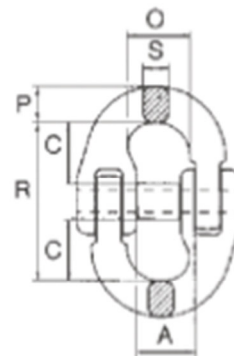

Na reťaz Chain		Kód Code	A	C	O	R	P	S	Váha Weight	W.L.L.
mm	inch		mm	mm	mm	mm	mm	mm	Kg	Kg
6	1/4	CLX 06	14	18	18	45	8	7,5	0,07	1400
7	9/32	CLX 07	17,8	20	20,5	50,5	10,2	9	0,14	1900
8	5/16	CLX 08	19	25,5	23,5	62	11,5	10	0,20	2500
10	3/8	CLX 10	23,8	30	27,5	72	12,6	12,6	0,35	4000
13	1/2	CLX 13	28	36	33,3	87,3	19	16,7	0,74	6700
16	5/8	CLX 16	34,3	40,5	39,5	105	20,6	20,6	1,16	10000
20	3/4	CLX 20	42	46	46	113	29	25	2,05	16000
22	7/8	CLX 22	49	55	58	133	30	28	3,10	19000
26	1	CLX 26	57	85	70	192	40	30	6,80	26500







## Zkracovací hák s okem tř.10

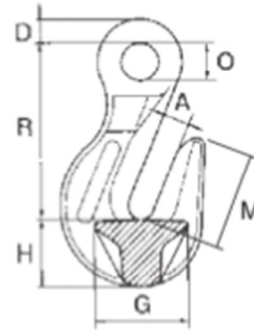

Na řetěz Chain		Kód Code	A	D	G	H	O	R	M	Váha Weight	W.L.L.
mm	inch		mm	mm	mm	mm	mm	mm	mm	Kg	Kg
6	1/4	CDX 06	8	8,5	22	22	12	51,5	35,5	0,18	1400
7-8	9/32-5/16	CDX 08	10	11	30	28	17	69	47	0,40	2500
10	3/8	CDX 10	13	15	44	34	22	86,5	55	0,88	4000
13	1/2	CDX 13	17	18	53	47	26	110,5	81	1,95	6700
16	5/8	CDX 16	19	21	64	60	32	129	92	3,20	10000
20	3/4	CDX 20	23,5	23	85	64	38	153	100	4,9	16000
22	7/8	CDX 22	26	26	92	65	41	180	121	7,5	19000
26	1	CDX 26	30,5	36	100	90	55	213	127	13	26500

## Zkracovací hák s vidlicí tř.10

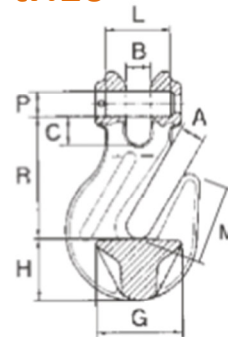

Na řetěz Chain		Kód Code	A	B	C	G	H	R	M	PxL	Váha Weight	W.L.L.
mm	inch		mm	mm	mm	mm	mm	mm	mm	mm	Kg	Kg
6	1/4	CFX 06	8	8	8,8	22	22	50,5	35,5	7,5x17,5	0,20	1400
7	9/32	CFX 07	10	10	11,4	30	28	65,5	47	9x22,5	0,44	1900
8	5/16	CFX 08	10	10	10,9	30	28	64,9	47	10x22,5	0,44	2500
10	3/8	CFX 10	13	13	15	44	34	79,9	55	13x31,5	0,96	4000
13	1/2	CFX 13	17	17	17,5	53	47	105,4	81	16x42	2,10	6700
16	5/8	CFX 16	19	19	18,3	64	60	111,8	92	21x51,5	3,40	10000
20	3/4	CFX 20	23,5	23	22	85	65	118	100	24x61,5	5,20	16000
22	7/8	CFX 22	26	26	25	92	68	154	120	26x72	7,80	19000





## Kontejnerový hák s okem –CWH tř.10

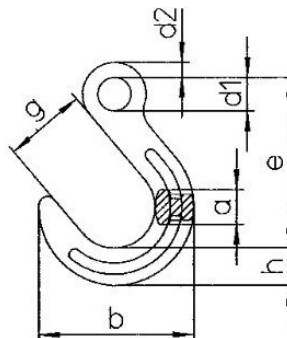
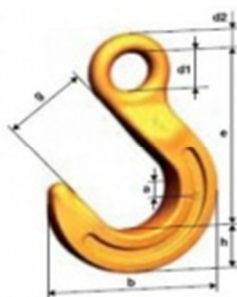

	Nosnost (kg)	e (mm)	h (mm)	a (mm)	d1 (mm)	d2 (mm)	g (mm)	b (mm)	Hmotnost (kg/ks)
7-8	2 500	131	29	25	24	11	64	118	0,92
10	4 000	158	35	32	31	14	76	143	1,77
13	6 700	190	42	40	39	17	89	170	2,82
16	10 000	224	50	46	47	22	102	200	5,03
19-20	16 000	260	61	54	56	28	114	231	7,6

## Kontejnerový hák s vidlicí – CWG tř.10

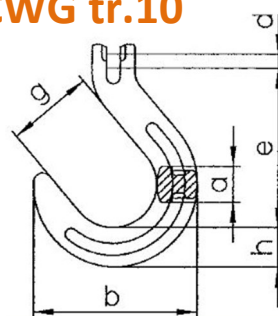
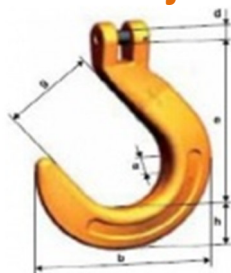

	Nosnost (kg)	e (mm)	h (mm)	a (mm)	g (mm)	d (mm)	b (mm)	Hmotnost (kg/ks)
7	1 900	120,5	29	25	64	9	118	1,00
8	2 500	120	29	25	64	10	118	1,00
10	4 000	140	35	32	76	12,5	143	1,78
13	6 700	169,5	42	40	89	16	170	2,96



## C-hák spojovací KCHW

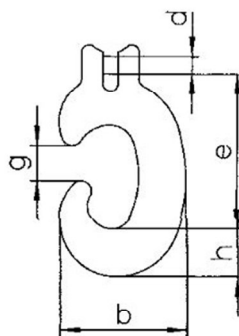
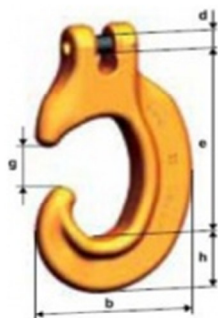

Typ	Nosnost (kg)	e (mm)	h (mm)	d (mm)	b (mm)	g (mm)	Hmotnost (kg/ks)
KCHW 7	1 900	90,5	27,5	9	73,5	20	0,5
KCHW 8	2 500	90	27,5	10	73,5	20	0,5
KCHW 10	4 000	129	38,5	12,5	107	28	1,4
KCHW 13	6 700	166	51	16	137	41	3
KCHW 16	10 000	205	60	20	166	45	5,3

## KV spojka tř.10

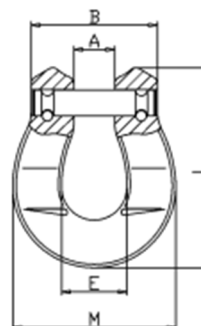

Size [mm]	Nominal dimensions [mm]					Pin [Ø mm]	Weight [kg/pc]	WLL Working load [t]
	A	B	E	M	L			
2	3	4	5	6	7	8	9	10
6	8	33	19,5	44	55	8	0,112	1,4
8	10	42	23,5	59,5	73	9,6	0,248	2,5
10	12	48	30	69,5	89	13	0,432	4
13	15,5	60	38	89,5	108,5	15,8	0,916	6,7
16	18,5	75,5	50	111,5	140	19,6	1,720	10